

KITCHEN

CLASS DESIGN

For Assistance Call **571-225-4972**

Email: **Classdesignkb@gmail.com**

Fax: **571-225-4972**

Customer Info

First Name: _____

Last Name: _____

Indicate the direction of the door swing.



Measure all objects on the wall (windows, doors, electrical outlets, gas lines, ventilation duct work, A/C vents).

Drawing Your Floor Plan

Use a pencil and the graph paper attached to design your new kitchen.

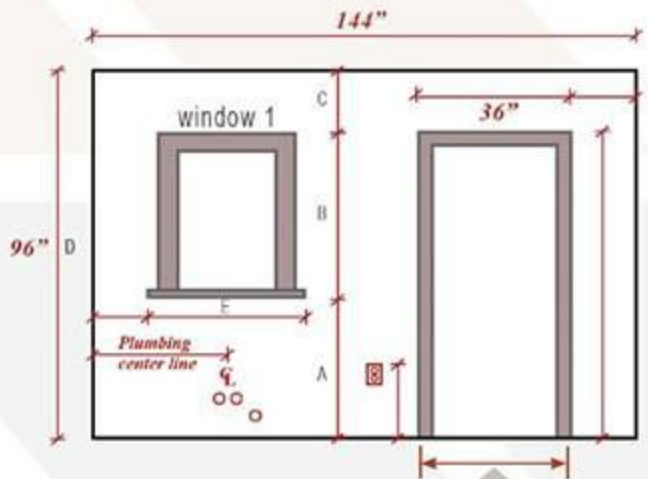
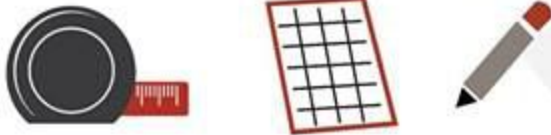

Measure all the window and door openings from outside trim edge to outside trim edge

How To Measure

Tip: Pick a corner to start. Then measure the full length of the wall. Continue around the whole room.

- Be sure to measure from the outside of the trim edge to the far wall.
- Make sure that all your measurements add up to the overall wall measurement.

Mark all your measurements in inches only, so 7'6" should be marked as 90".

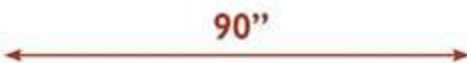

Window Measurements

Name Width Height Distance From Floor

Name	Width	Height	Distance From Floor

KITCHEN

CLASS DESIGN

For Assistance Call 571-225-4972

Email: Classdesignkb@gmail.com

Fax: 571-225-4972

Customer Info

First Name: _____

Last Name: _____

Email: _____

Phone: _____

About Your Space

Ceiling Height: _____

Wall Cabinet Height: _____

If applicable

Soffit Height: _____

Soffit Depth: _____

Are there any other limitations?
(plumbing, electric, flooring, etc.)

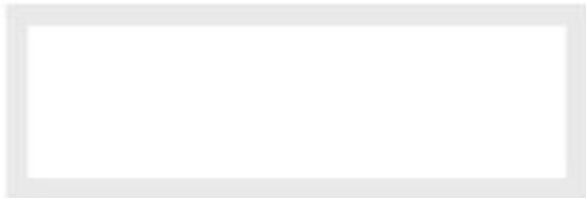

Your New Kitchen

Primary Door Style & Finish: _____

Accent Door Style & Finish: _____

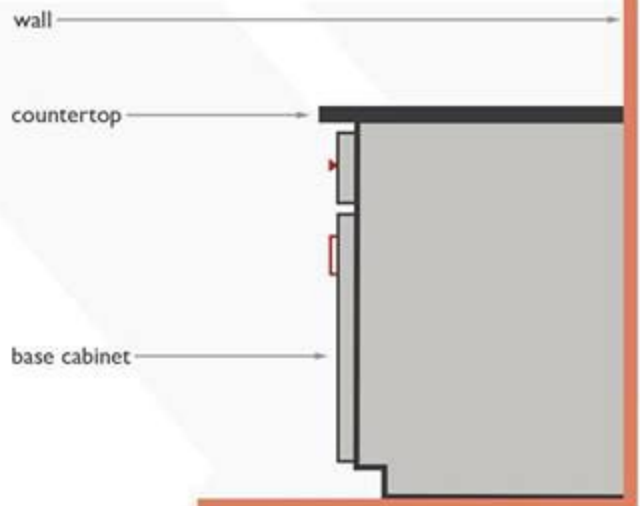
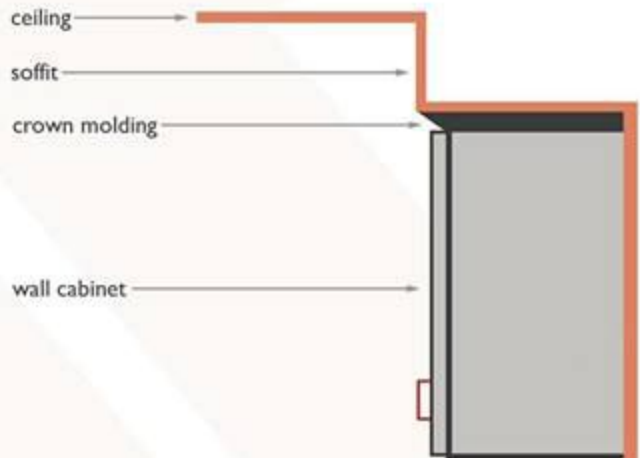

Please check any extras you prefer:

- | | | |
|---|---|--|
| <input type="checkbox"/> Wine Storage | <input type="checkbox"/> Light Rail Molding | <input type="checkbox"/> Cutlery Divider |
| <input type="checkbox"/> Plate Rack | <input type="checkbox"/> Open Shelves | |
| <input type="checkbox"/> Crown Molding | <input type="checkbox"/> Garbage Pull Out Cabinet | |
| <input type="checkbox"/> Crown Molding to the Ceiling | <input type="checkbox"/> Spice Pull Out Cabinet | |
| <input type="checkbox"/> Roll Out Trays | <input type="checkbox"/> Lazy Susan | |
| <input type="checkbox"/> Glass Doors | <input type="checkbox"/> Microwave Upper Cabinet | |
| <input type="checkbox"/> Decorative Door Panels | <input type="checkbox"/> Microwave Base Cabinet | |
| <input type="checkbox"/> Wood Hood | <input type="checkbox"/> Wide Storage Drawer(s) | |
| <input type="checkbox"/> Base Molding | <input type="checkbox"/> Soft Close Doors | |

KITCHEN



CLASS DESIGN

Customer Info

For Assistance Call **571-225-4972**
Email: Classdesignkb@gmail.com
Fax: **571-225-4972**

First Name: _____ Last Name: _____

Transfer all information to the design grid and include actual measurements in inches.

A large, empty grid for design, consisting of 20 columns and 30 rows of small squares. The grid is used for transferring information and including actual measurements in inches.

KITCHEN

CLASS DESIGN

For Assistance Call **571-225-4972**

Email: **Classdesignkb@gmail.com**

Fax: **571-225-4972**

Customer Info

First Name: _____

Last Name: _____

In order to do a complete design we will need to know the exact sizes of all the appliances that are going to be used in the new kitchen design. If you have any *Manufacturer Spec Sheets*, please include them in your email or fax along with your kitchen planning guide.



Appliances In Your New Kitchen

Range

Brand/Model	Width	Depth	Height
-------------	-------	-------	--------

<input type="text"/>	<input type="text"/>	<input type="text"/>	<input type="text"/>
----------------------	----------------------	----------------------	----------------------

Cook-top

Brand/Model	Width	Depth	Height
-------------	-------	-------	--------

<input type="text"/>	<input type="text"/>	<input type="text"/>	<input type="text"/>
----------------------	----------------------	----------------------	----------------------

Oven

Brand/Model	Width	Depth	Height
-------------	-------	-------	--------

<input type="text"/>	<input type="text"/>	<input type="text"/>	<input type="text"/>
----------------------	----------------------	----------------------	----------------------

Hood

Brand/Model	Width	Depth	Height
-------------	-------	-------	--------

<input type="text"/>	<input type="text"/>	<input type="text"/>	<input type="text"/>
----------------------	----------------------	----------------------	----------------------

Microwave

Brand/Model	Width	Depth	Height
-------------	-------	-------	--------

<input type="text"/>	<input type="text"/>	<input type="text"/>	<input type="text"/>
----------------------	----------------------	----------------------	----------------------

Refrigerator

Brand/Model	Width	Depth	Height
-------------	-------	-------	--------

<input type="text"/>	<input type="text"/>	<input type="text"/>	<input type="text"/>
----------------------	----------------------	----------------------	----------------------

Dishwasher

Brand/Model	Width	Depth	Height
-------------	-------	-------	--------

<input type="text"/>	<input type="text"/>	<input type="text"/>	<input type="text"/>
----------------------	----------------------	----------------------	----------------------

Other

Brand/Model	Width	Depth	Height
-------------	-------	-------	--------

<input type="text"/>	<input type="text"/>	<input type="text"/>	<input type="text"/>
----------------------	----------------------	----------------------	----------------------